

I-96 STAGE 1 TYPICAL 1 (OFF-PEAK TIMES)

SECTION APPLIES:
POB TO WIXOM

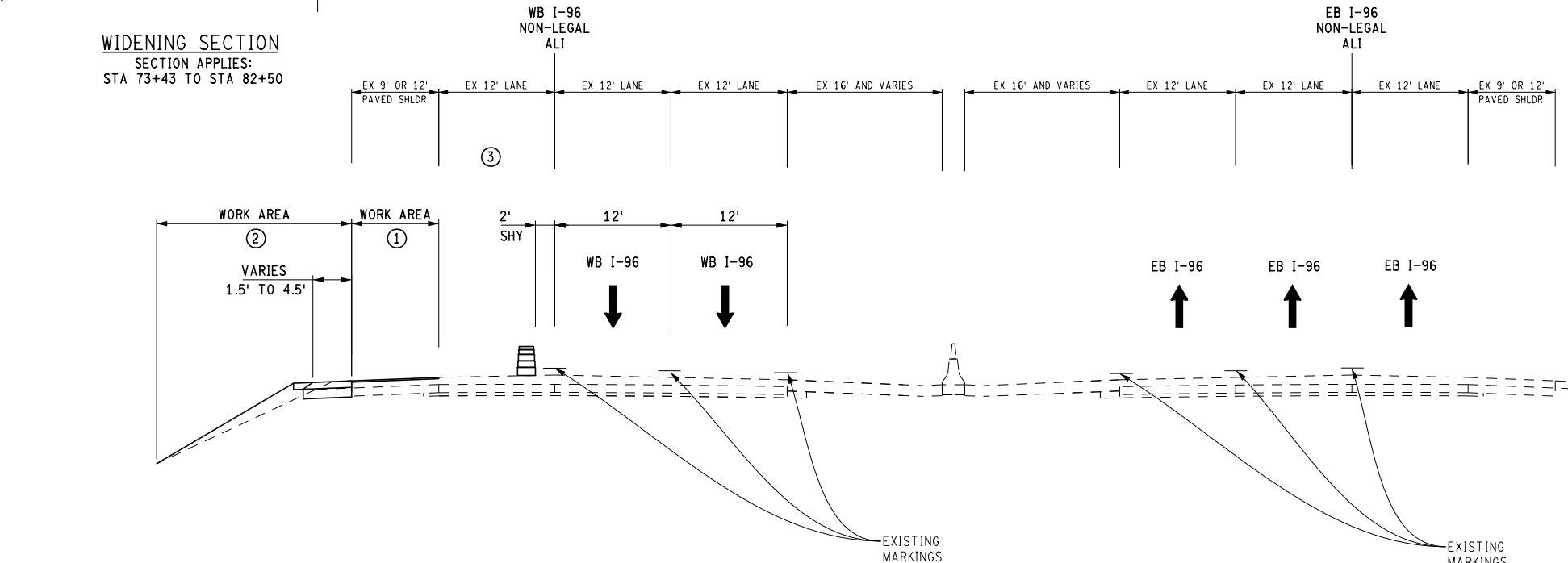

I-96 STAGE 1 TYPICAL 2 (OFF-PEAK TIMES)

SECTION APPLIES:
WIXOM TO POE

WIDENING SECTION
SECTION APPLIES:
STA 73+43 TO STA 82+50

- ① WORK AREA- MAKE OUTSIDE SHOULDER DRIVEABLE. FILL IN EXISTING CORRUGATIONS, POTENTIALLY COLD-MILL AND HMA OVERLAY ENTIRE HMA SHOULDER SURFACE.
- ② WORK AREA- WIDEN WB OUTSIDE SHOULDER STA 482+50 TO 525+05, STA 539+70 TO STA 542+30, AND STA 554+93 TO STA 556+19 TO PROVIDE PAVED SHOULDER NEAR POB FOR STAGE 3A SHIFTED TRAFFIC AND AT THE WEAVE LANE BETWEEN NOVI RD AND BECK ROAD FOR STAGE 3B SHIFTED TRAFFIC.
- ③ LANE OPEN DURING PEAK HOURS.

FINAL ROW PLAN REVISIONS (SUBMITTAL DATE:)								Access ENGINEERING, INC.		MDOT Michigan Department of Transportation		DATE: 10/02/20		CS: 63022		DRAWING		SHEET	
NO.	DATE	AUTH	DESCRIPTION	NO.	DATE	AUTH	DESCRIPTION	0 VERT. (FT) 16		0 HORZ. (FT) 16		DESIGN UNIT: MARZ		JN: 124103		MAINTAINING TRAFFIC TYPICALS		I-96 MTTYP 1	
								FILE: 124103PE_STG1.dgn		TSC: OAKLAND				I-96 FLEX ROUTE		STAGE 1		SECT 1	

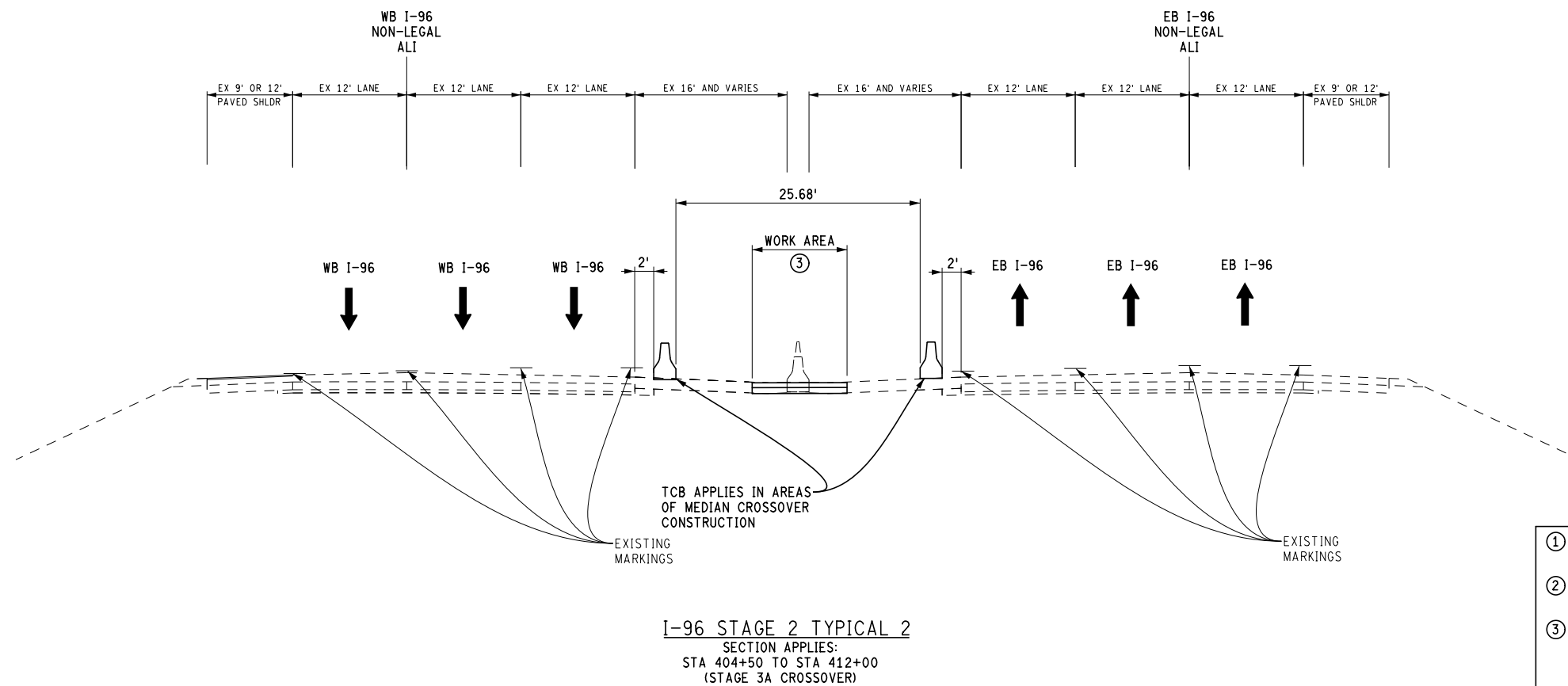
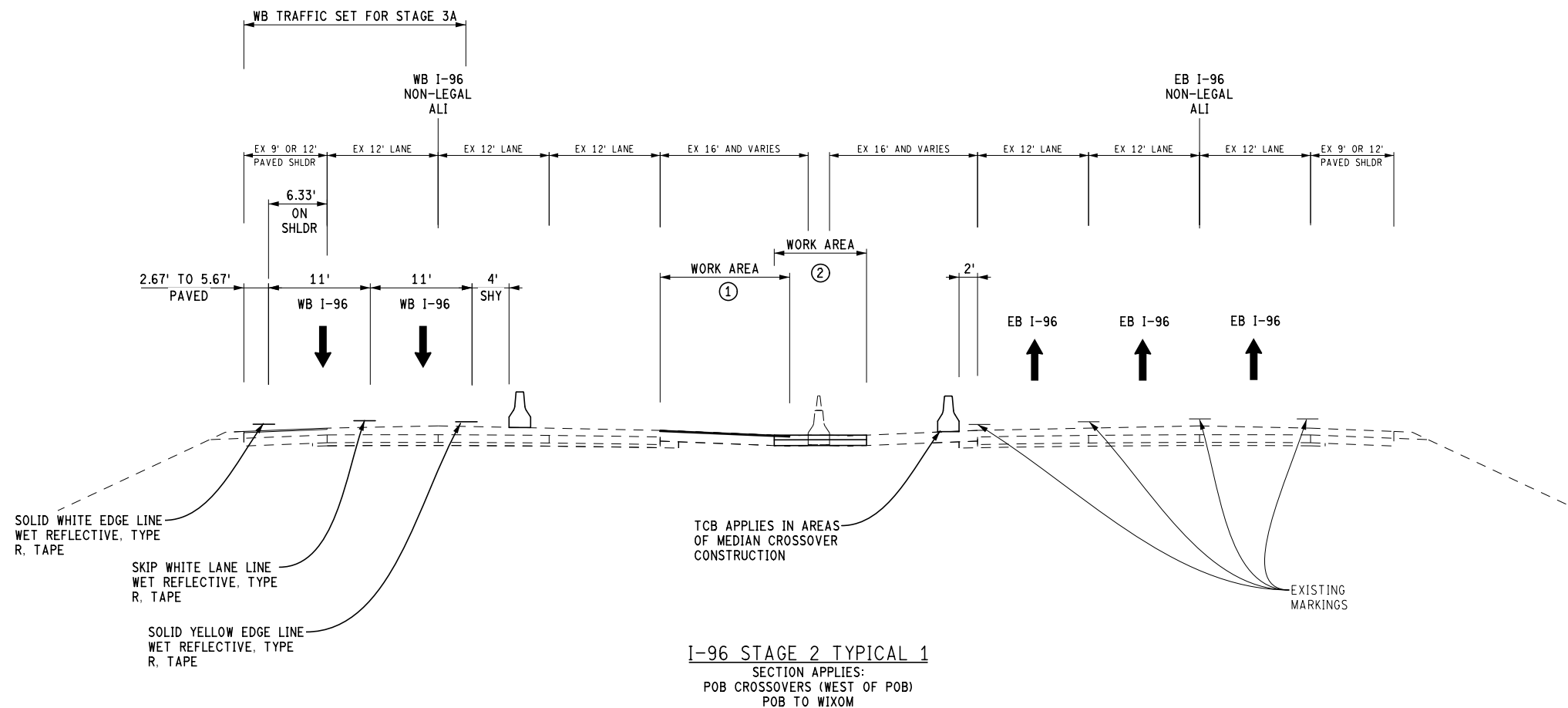

- ① WORK AREA- REMOVE EXISTING MEDIAN BARRIER WALL AND CONSTRUCT MEDIAN DRAINAGE.
- ② WORK AREA- PAVE TEMP PAVEMENT ALONG WB MEDIAN SHOULDER FOR STAGE 3A TRAFFIC.
- ③ WORK AREA- REMOVE EXISTING MEDIAN BARRIER WALL AND SAWCUT AND REMOVE A PORTION OF THE EXISTING EB AND WB MEDIAN SHOULDER AND PLACE TEMP PAVEMENT FOR STAGE 3A TEMPORARY MEDIAN CROSSOVERS.

FINAL ROW PLAN REVISIONS		(SUBMITTAL DATE:)	
NO.	DATE	AUTH	DESCRIPTION

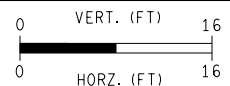

FILE: 124103PE_STG2.dgn

DATE: 10/02/20
DESIGN UNIT: MARZ
TSC: OAKLAND

CS: 63022
JN: 124103

MAINTAINING TRAFFIC TYPICALS
I-96 FLEX ROUTE
STAGE 2

DRAWING SHEET
I-96 MTTYP 2
SECT 1

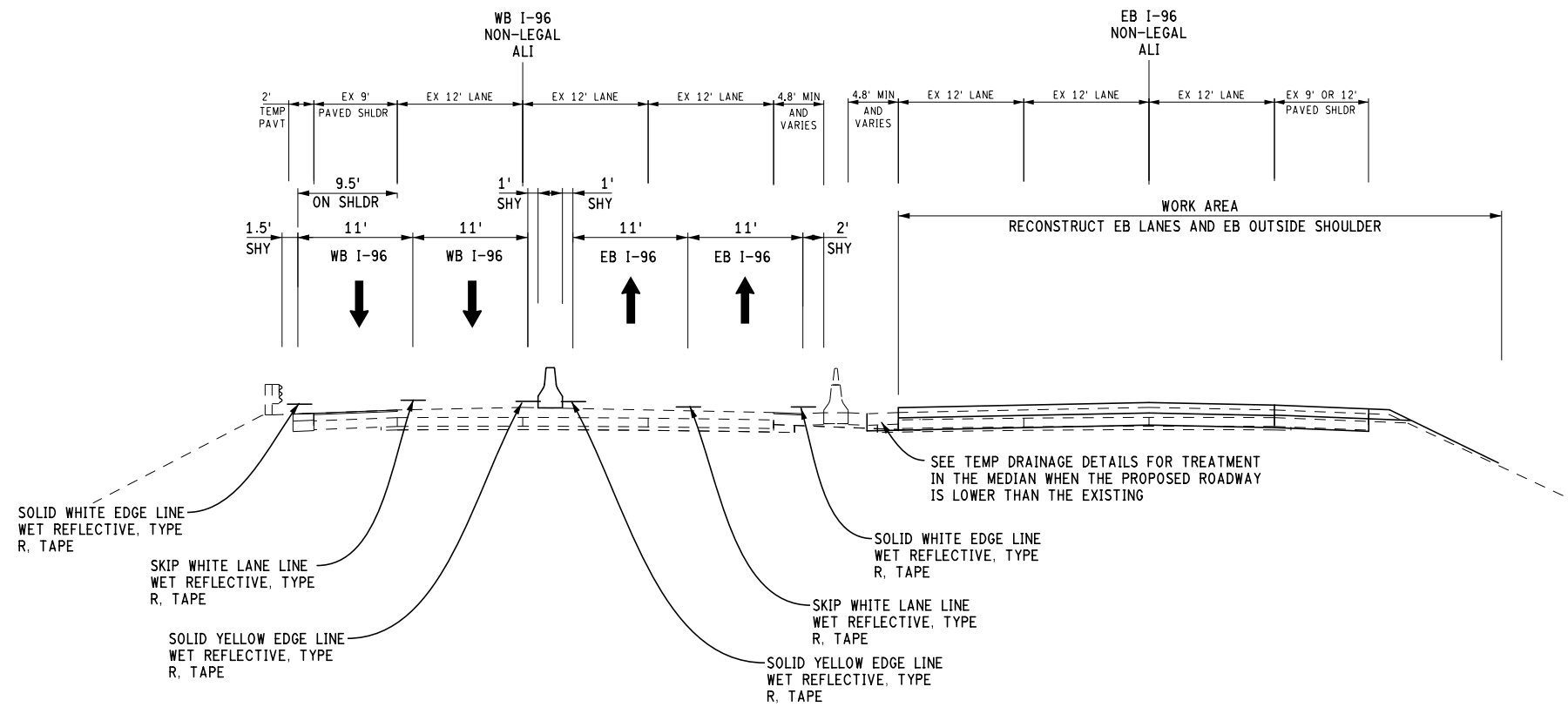

I-96 STAGE 3A TYPICAL 1

SECTION APPLIES:
POB TO STA 80+58

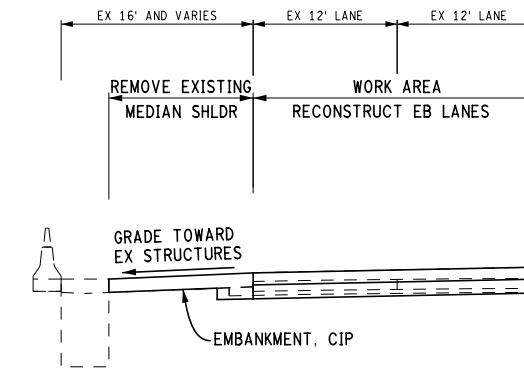

**TEMP DRAINAGE DETAIL
WHEN PROPOSED EB I-96
IS BELOW EXISTING 0" TO 5"**

SECTION APPLIES:
POB TO WIXOM

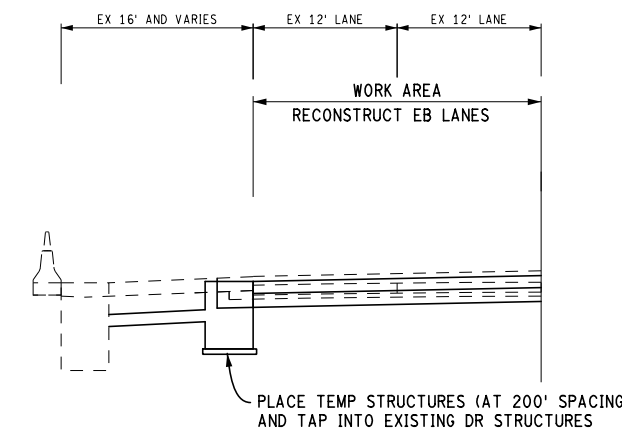

**TEMP DRAINAGE DETAIL
WHEN PROPOSED EB I-96
IS BELOW EXISTING MORE THAN 5"**

SECTION APPLIES:
EB I-96
STA 217+00 TO STA 220+50
STA 229+50 TO STA 230+50
STA 241+00 TO STA 246+00
STA 314+00 TO STA 316+00
STA 326+50 TO STA 327+50
STA 336+50 TO STA 338+50
STA 348+50 TO STA 352+50
STA 394+00 TO STA 399+50

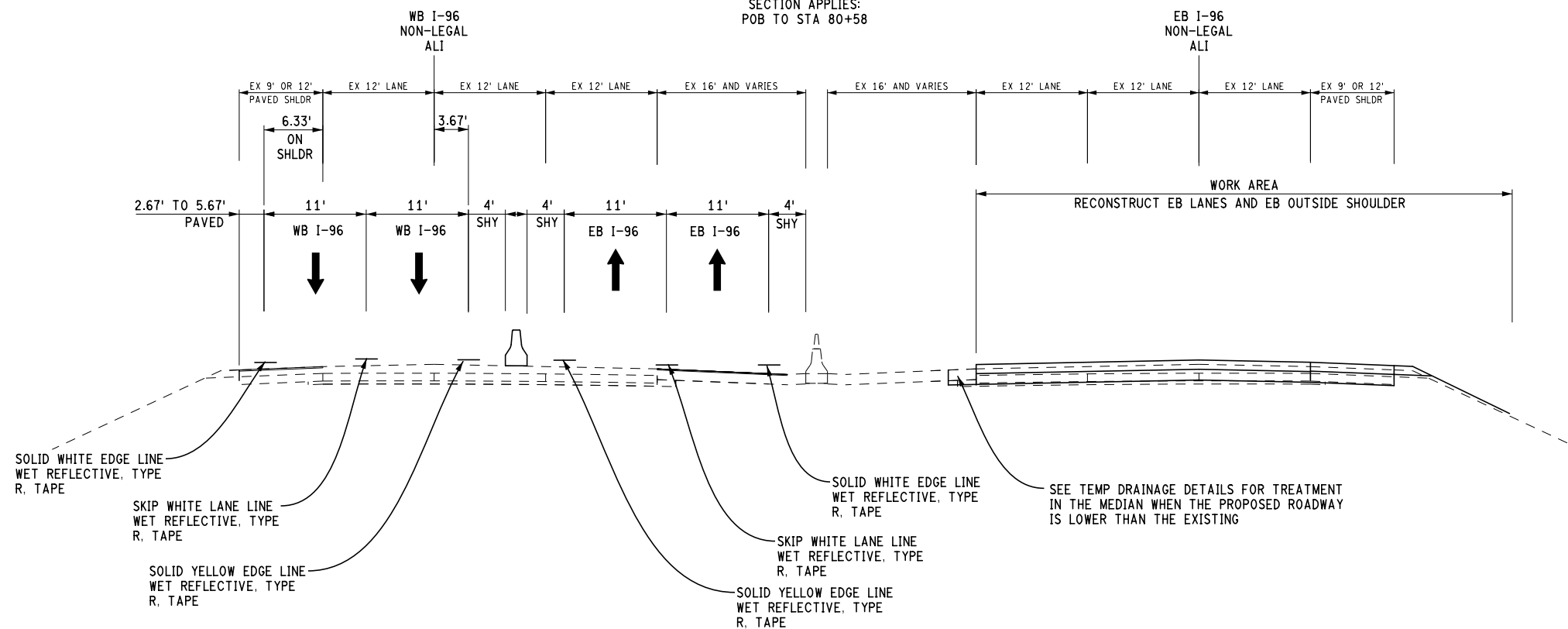

I-96 STAGE 3A TYPICAL 2

SECTION APPLIES:
STA 80+58 TO STA 405+00

- ① WORK AREA- MAKE MEDIAN SHOULDER DRIVEABLE. FILL IN EXISTING CORRUGATIONS, POTENTIALLY COLD-MILL AND HMA OVERLAY ENTIRE HMA SHOULDER SURFACE.
- ② WEAVE APPLIES BETWEEN WIXOM AND BECK ROADS.

FINAL ROW PLAN REVISIONS (SUBMITTAL DATE:)					
NO.	DATE	AUTH	DESCRIPTION	NO.	DATE

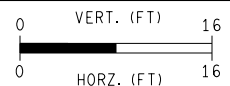

FILE: 124103PE_STG3A-1.dgn

DATE: 10/02/20

DESIGN UNIT: MARZ

TSC: OAKLAND

CS: 63022

JN: 124103

MAINTAINING TRAFFIC TYPICALS

I-96 FLEX ROUTE

STAGE 3A

DRAWING SHEET

I-96 MTTYP 3

SECT 1

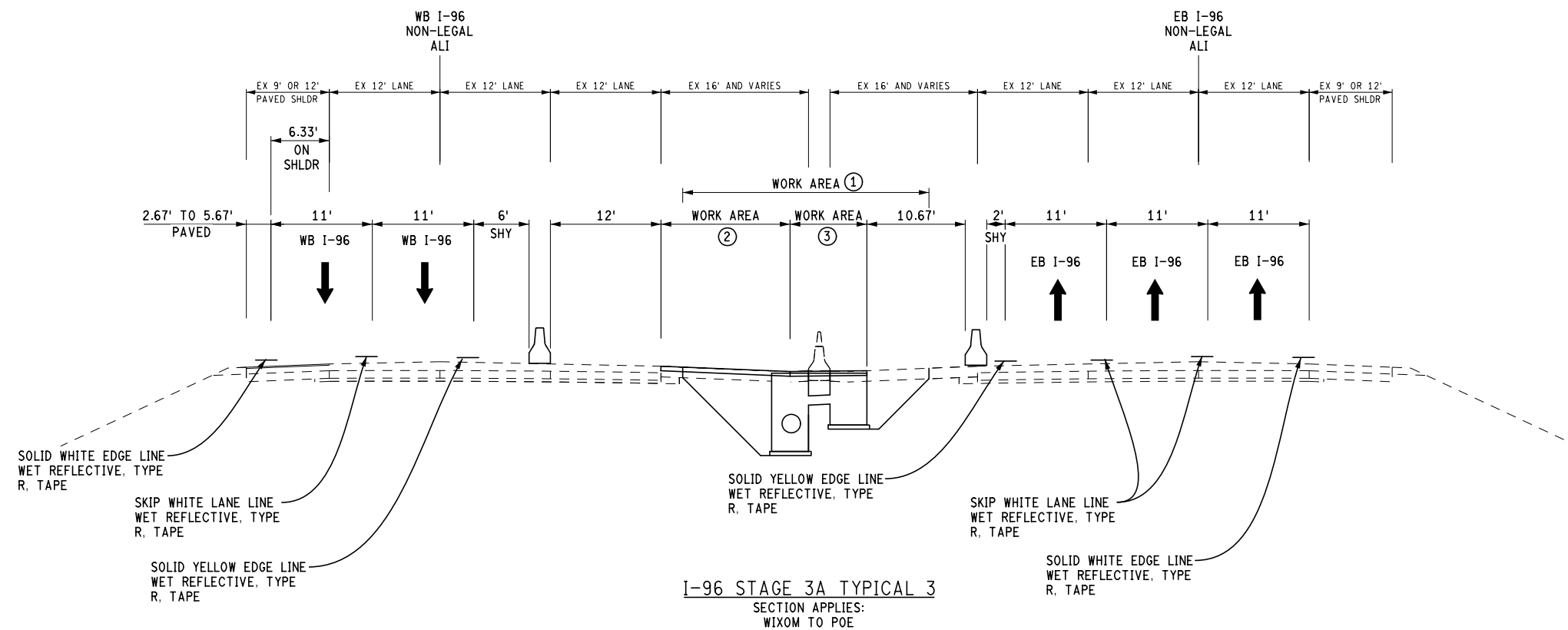

- ① WORK AREA- REMOVE EXISTING MEDIAN BARRIER WALL AND CONSTRUCT MEDIAN DRAINAGE.
- ② WORK AREA- PAVE TEMP PAVEMENT ALONG WB MEDIAN SHOULDER FOR STAGE 5 TRAFFIC.
- ③ WORK AREA- REMOVE A PORTION OF THE EXISTING EB MEDIAN SHOULDER AND PLACE TEMP PAVEMENT. SEE PLANS FOR WIDTH OF REMOVAL AND TEMP PAVEMENT LIMITS.

FINAL ROW PLAN REVISIONS		(SUBMITTAL DATE:)	
NO.	DATE	AUTH	DESCRIPTION

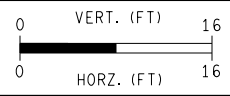

FILE: 124103PE_STG3A-2.dgn

DATE: 10/02/20
DESIGN UNIT: MARZ
TSC: OAKLAND

CS: 63022
JN: 124103

MAINTAINING TRAFFIC TYPICALS
I-96 FLEX ROUTE
STAGE 3A

DRAWING SHEET
I-96 MTTYP 4
SECT 1

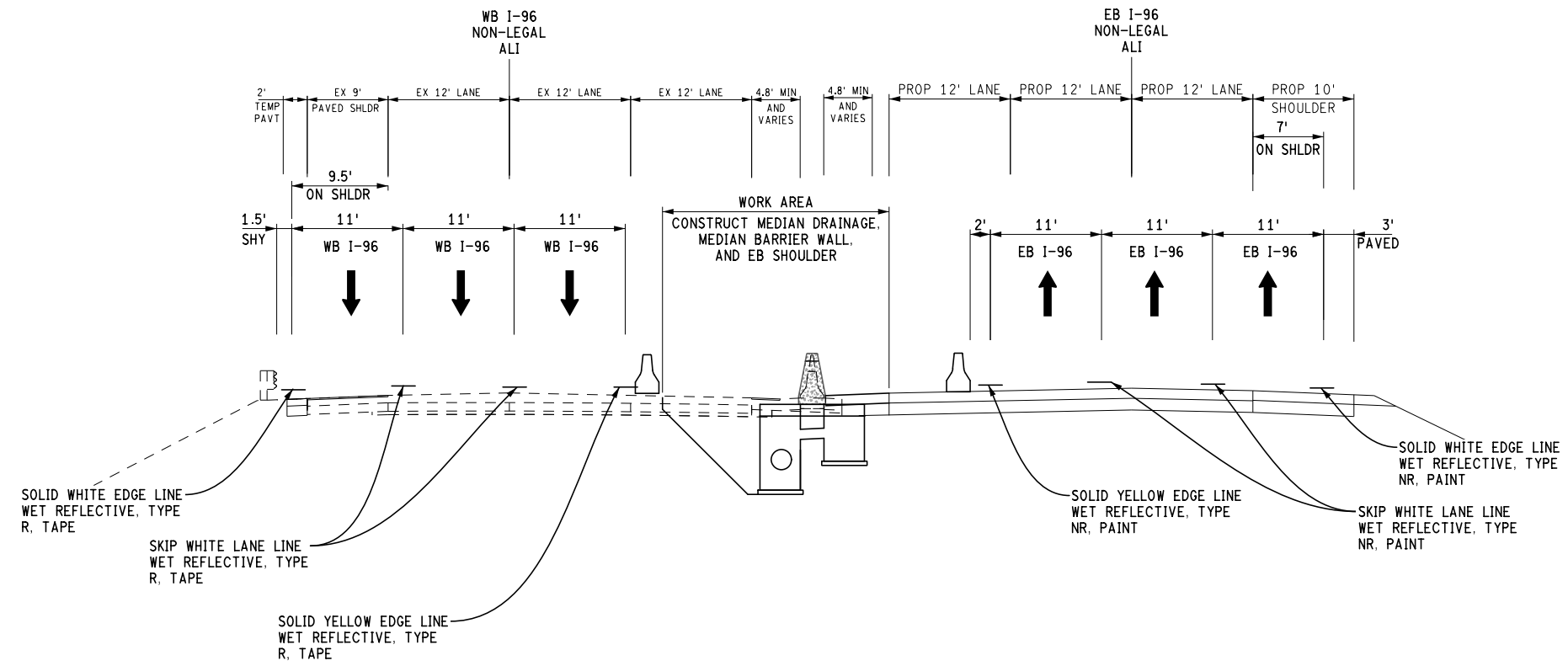

I-96 STAGE 3B TYPICAL 1

SECTION APPLIES:
POB TO STA 80+58

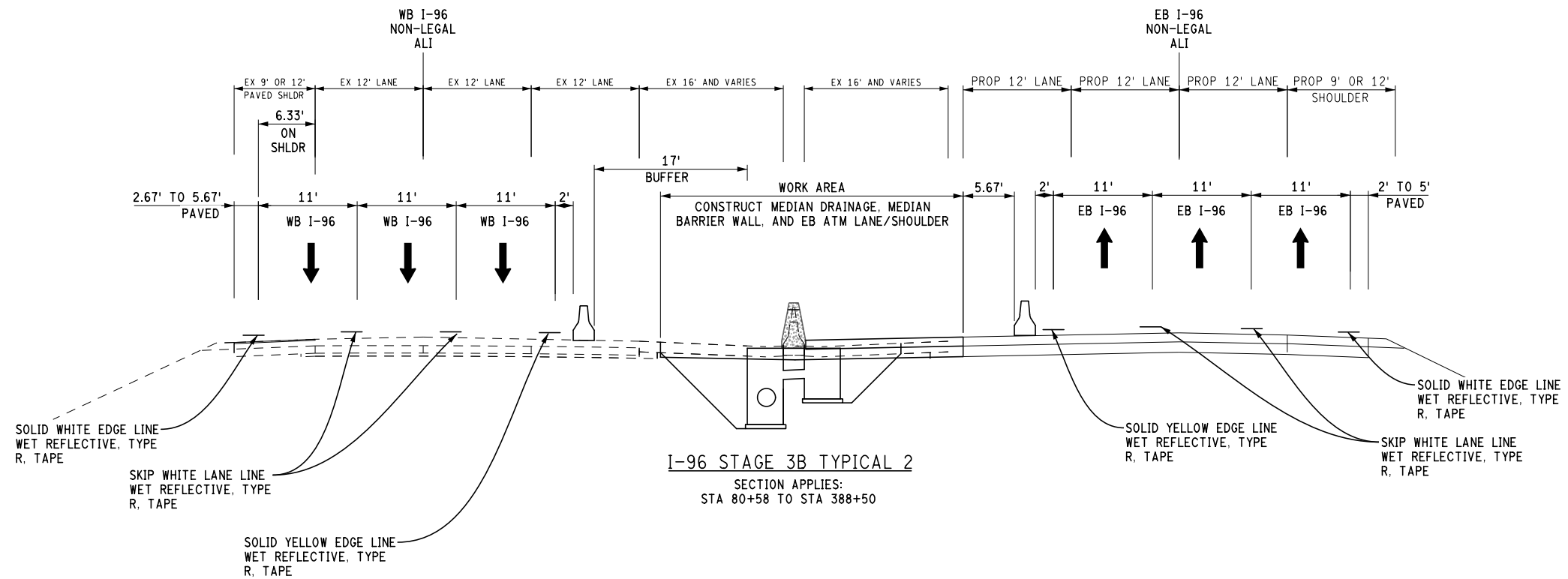

I-96 STAGE 3B TYPICAL 2

SECTION APPLIES:
STA 80+58 TO STA 388+50

FINAL ROW PLAN REVISIONS (SUBMITTAL DATE:)							
NO.	DATE	AUTH	DESCRIPTION	NO.	DATE	AUTH	DESCRIPTION

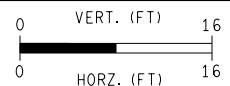

FILE: 124103PE_STG3B-1.dgn

DATE: 10/02/20
DESIGN UNIT: MARZ
TSC: OAKLAND

CS: 63022
JN: 124103

MAINTAINING TRAFFIC TYPICALS
I-96 FLEX ROUTE
STAGE 3B

DRAWING SHEET
I-96 MTTYP 5 SECT 1

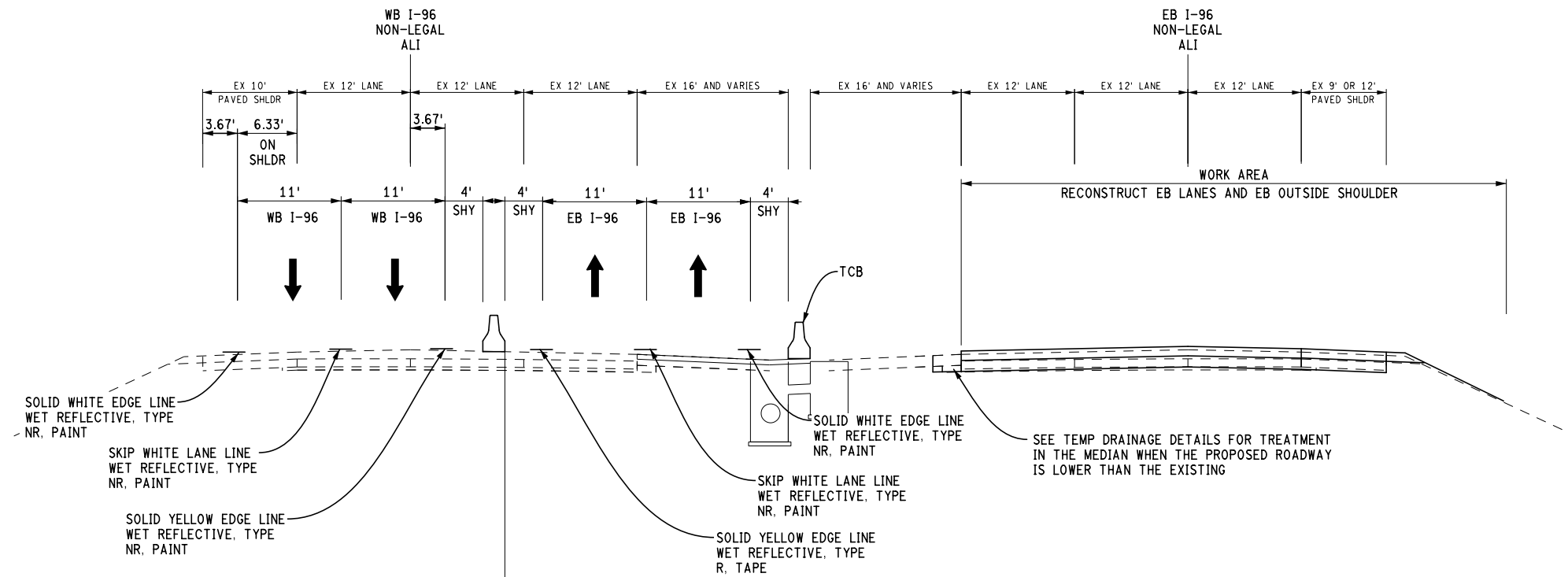

I-96 STAGE 3B TYPICAL 3
SECTION APPLIES:
STA 388+50 TO STA 464+00

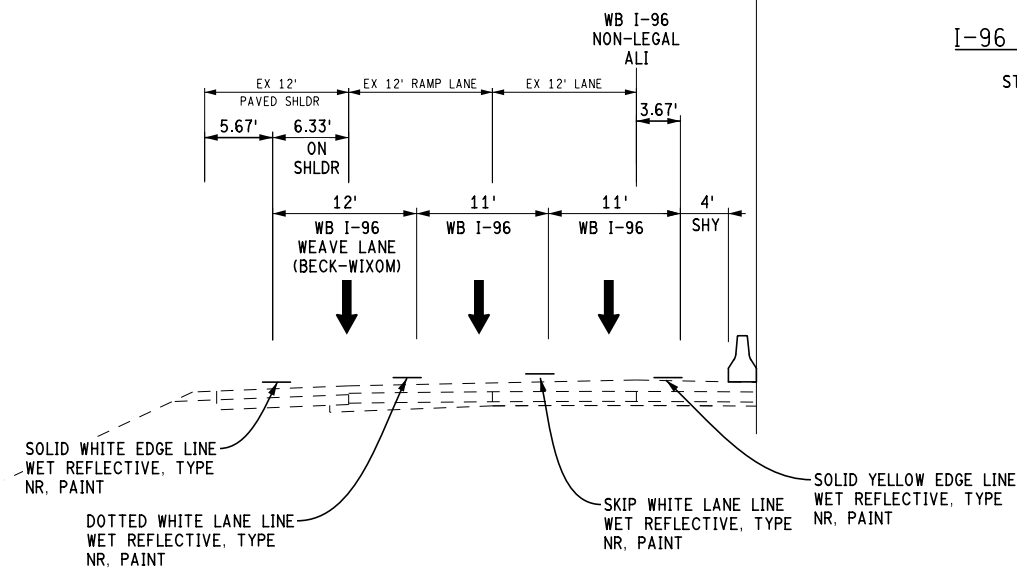

WEAVE LANE (BECK-WIXOM)
SECTION APPLIES:
STA 417+83 TO STA 447+27

FINAL ROW PLAN REVISIONS		(SUBMITTAL DATE:)	
NO.	DATE	AUTH	DESCRIPTION

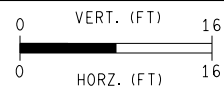

FILE: 124103PE_STG3B-2.dgn

DATE: 10/02/20
DESIGN UNIT: MARZ
TSC: OAKLAND

CS: 63022
JN: 124103

MAINTAINING TRAFFIC TYPICALS
I-96 FLEX ROUTE
STAGE 3B

DRAWING SHEET
I-96 MTTYP 6
SECT 1

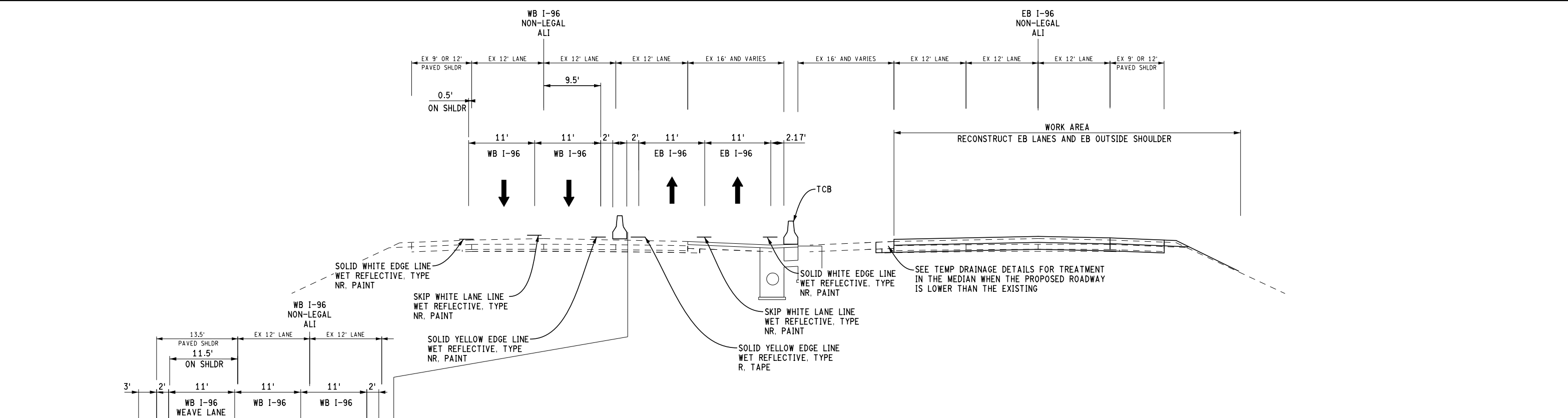

I-96 STAGE 3B TYPICAL 4

SECTION APPLIES:
STA 464+00 TO STA 576+00

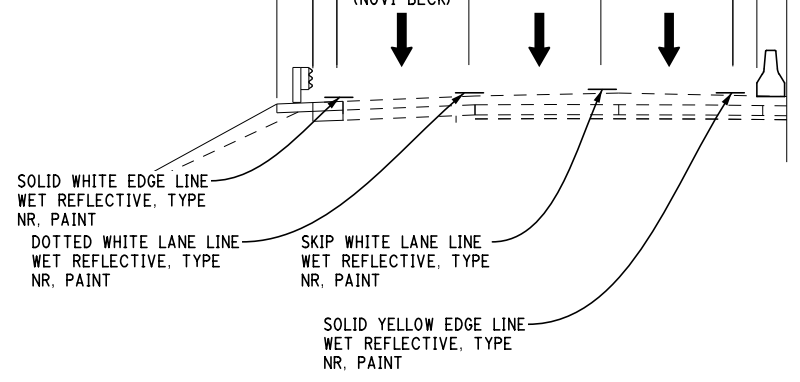

WEAVE LANE (NOVI-BECK)
SECTION APPLIES:
STA 478+14 TO STA 568+43

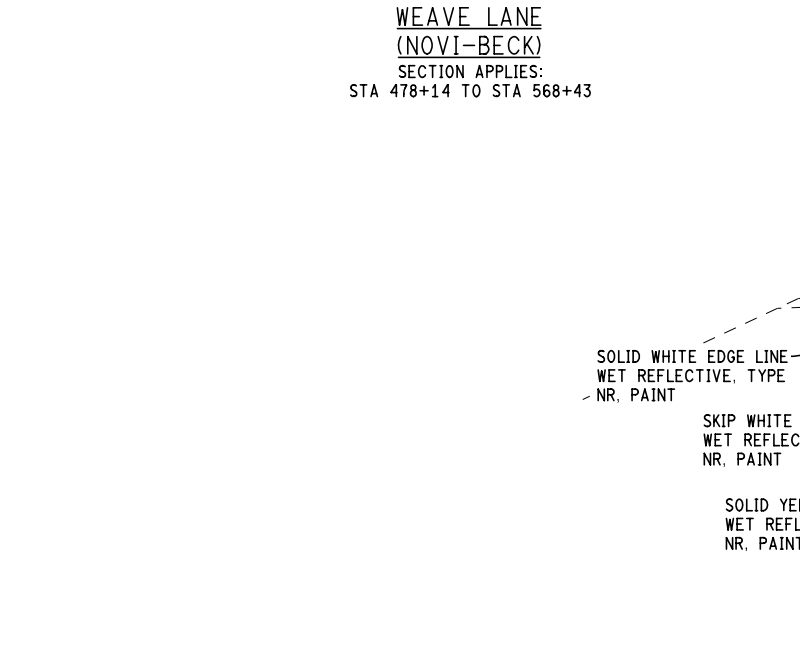

I-96 STAGE 3B TYPICAL 5

SECTION APPLIES:
STA 576+00 TO POE

FINAL ROW PLAN REVISIONS (SUBMITTAL DATE:)							
NO.	DATE	AUTH	DESCRIPTION	NO.	DATE	AUTH	DESCRIPTION

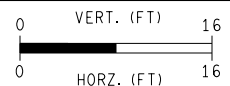

FILE: 124103PE_STG3B-3.dgn

DATE: 10/02/20
DESIGN UNIT: MARZ
TSC: OAKLAND

CS: 63022
JN: 124103

MAINTAINING TRAFFIC TYPICALS
I-96 FLEX ROUTE
STAGE 3B

DRAWING SHEET
I-96 MTYP 7
SECT 1

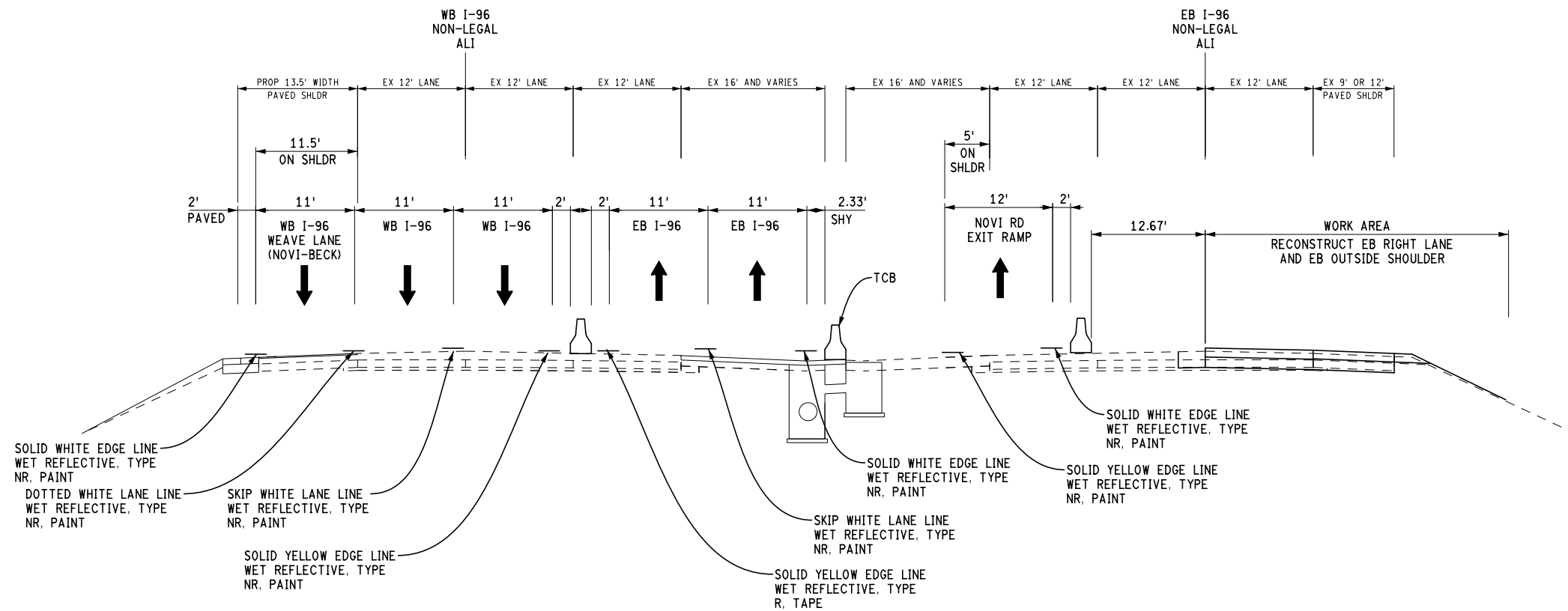

I-96 STAGE 3B TYPICAL 6 RT
 EXIT RAMP CROSSOVER TO NOVI RD- CONSTRUCT RIGHT LANE/SHLDR
 SECTION APPLIES:
 STA 506+50 TO STA 557+34

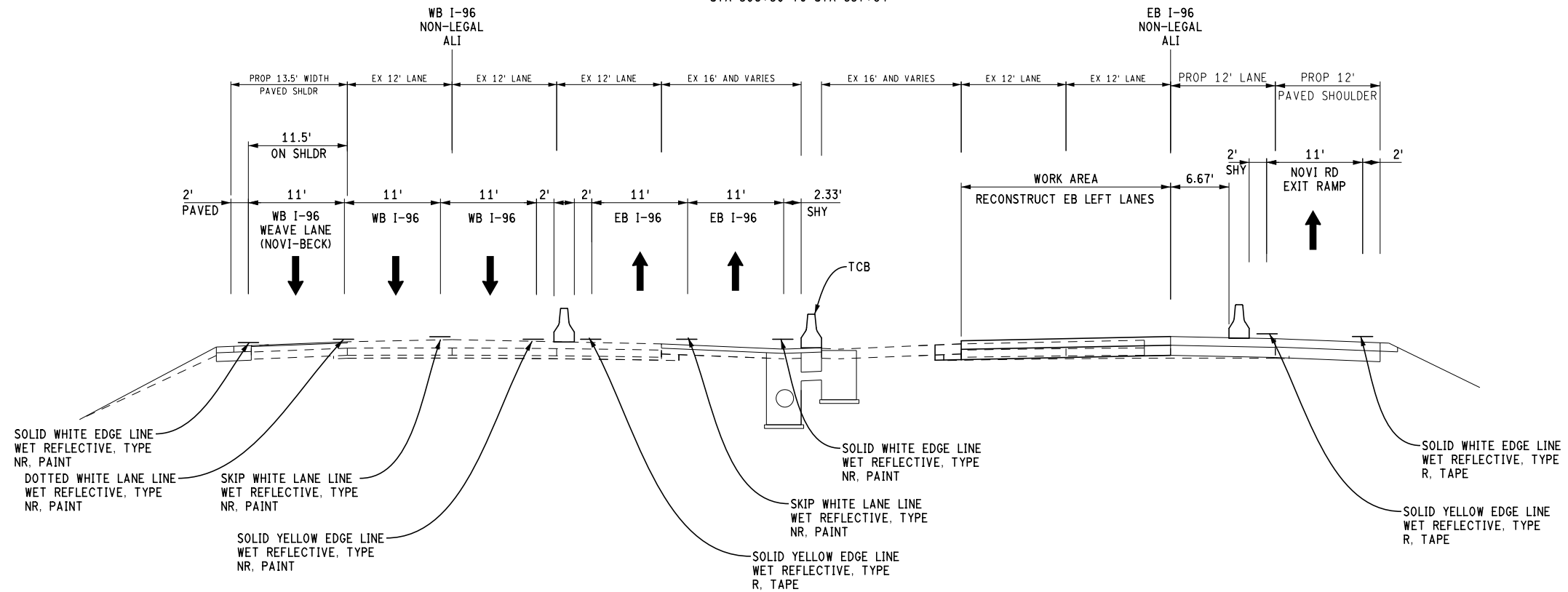

I-96 STAGE 3B TYPICAL 6 LT
 EXIT RAMP CROSSOVER TO NOVI RD- CONSTRUCT LEFT LANES
 SECTION APPLIES:
 STA 499+84 TO STA 557+34

FINAL ROW PLAN REVISIONS (SUBMITTAL DATE:)							
NO.	DATE	AUTH	DESCRIPTION	NO.	DATE	AUTH	DESCRIPTION

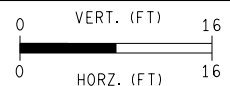

DATE: 10/02/20
 DESIGN UNIT: MARZ
 TSC: OAKLAND
 FILE: 124103PE_STG3B-4.dgn

CS: 63022
 JN: 124103

MAINTAINING TRAFFIC TYPICALS
 I-96 FLEX ROUTE
 STAGE 3B

DRAWING SHEET
 I-96 MT TYP 7
 SECT 1

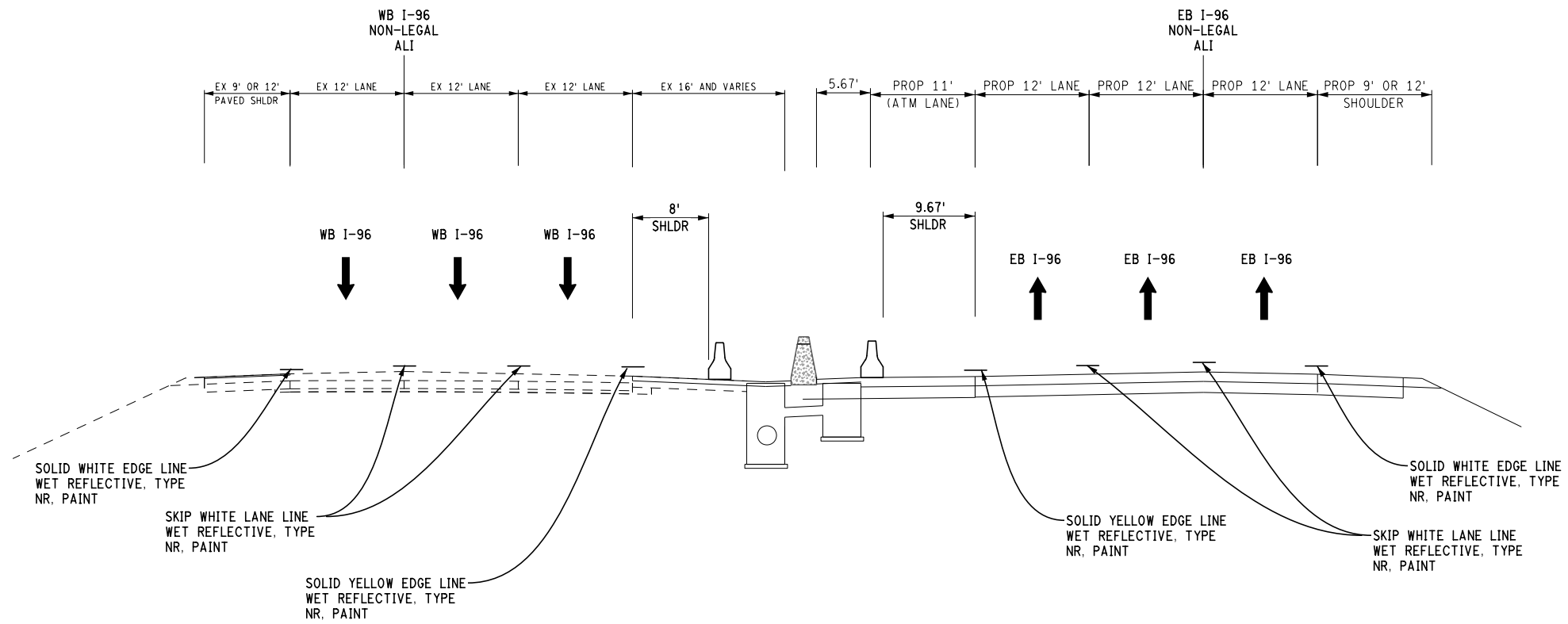

I-96 STAGE 4 TYPICAL 1
SECTION APPLIES:
POB TO STA 388+50

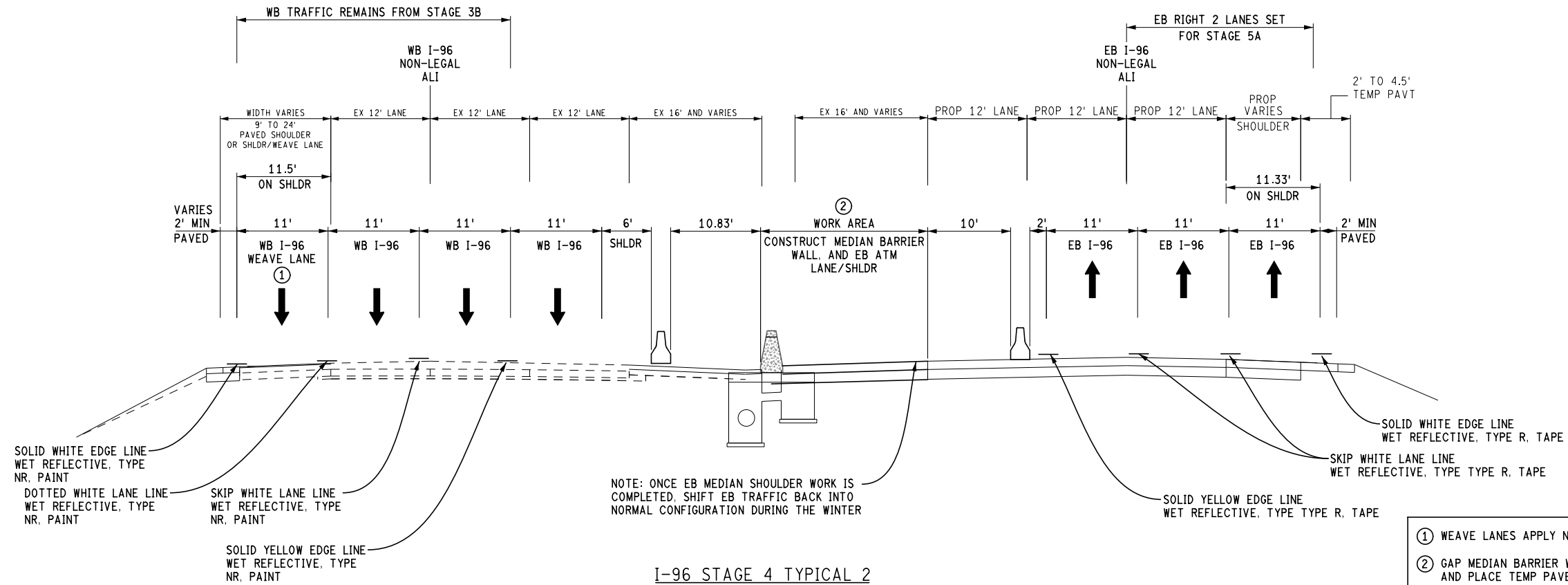

I-96 STAGE 4 TYPICAL 2
SECTION APPLIES:
STA 431+30 TO POE

- ① WEAVE LANES APPLY NOVI TO BECK AND BECK TO WIXOM.
- ② GAP MEDIAN BARRIER WALL AND EB/WB VALLEY GUTTERS AND PLACE TEMP PAVEMENT IN THE MEDIAN FOR STAGE 5A/5B CROSSOVERS BETWEEN STA 478+80 AND STA 487+75 AND BETWEEN STA 601+35 AND STA 607+50.

FINAL ROW PLAN REVISIONS (SUBMITTAL DATE:)							
NO.	DATE	AUTH	DESCRIPTION	NO.	DATE	AUTH	DESCRIPTION

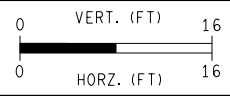

FILE: 124103PE_STG4.dgn

DATE: 10/02/20
DESIGN UNIT: MARZ
TSC: OAKLAND

CS: 63022
JN: 124103

MAINTAINING TRAFFIC TYPICALS
I-96 FLEX ROUTE
STAGE 4

DRAWING SHEET
I-96 MTTYP 8
SECT 1

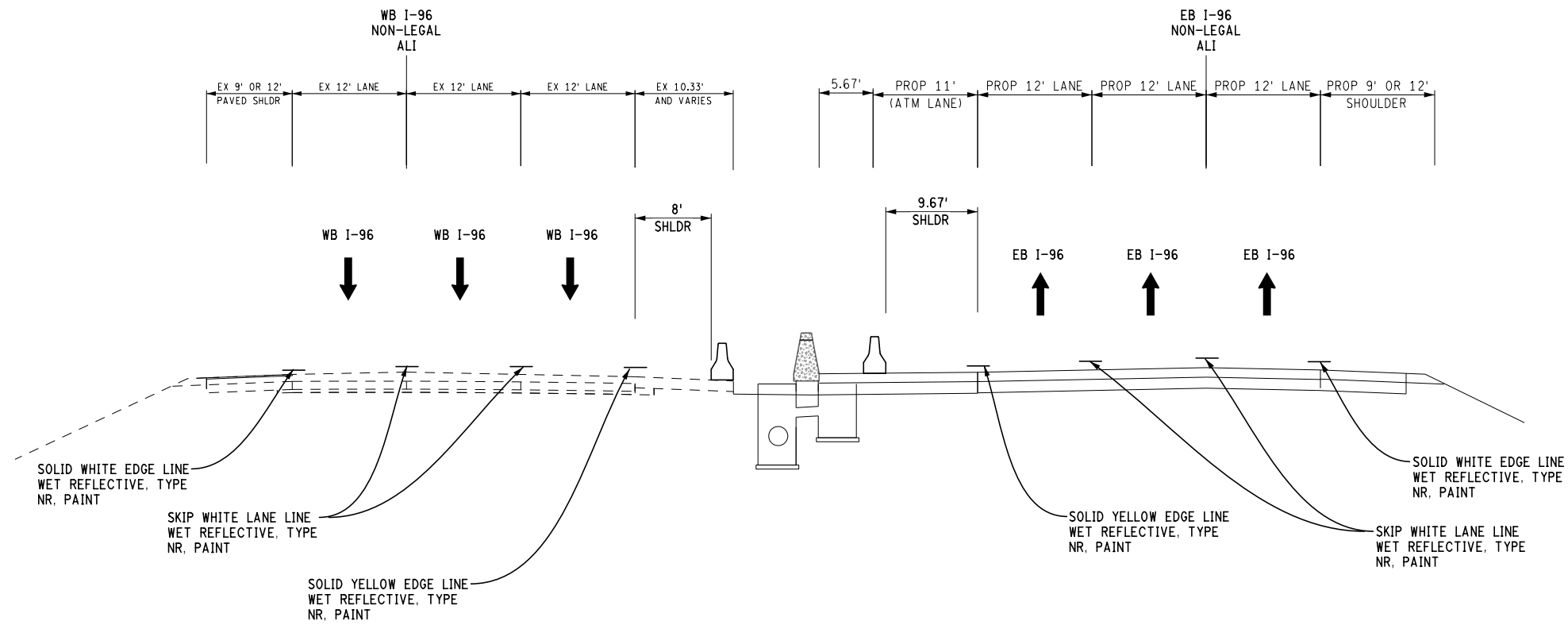

I-96 STAGE 5A TYPICAL 1

SECTION APPLIES:
POB TO WIXOM

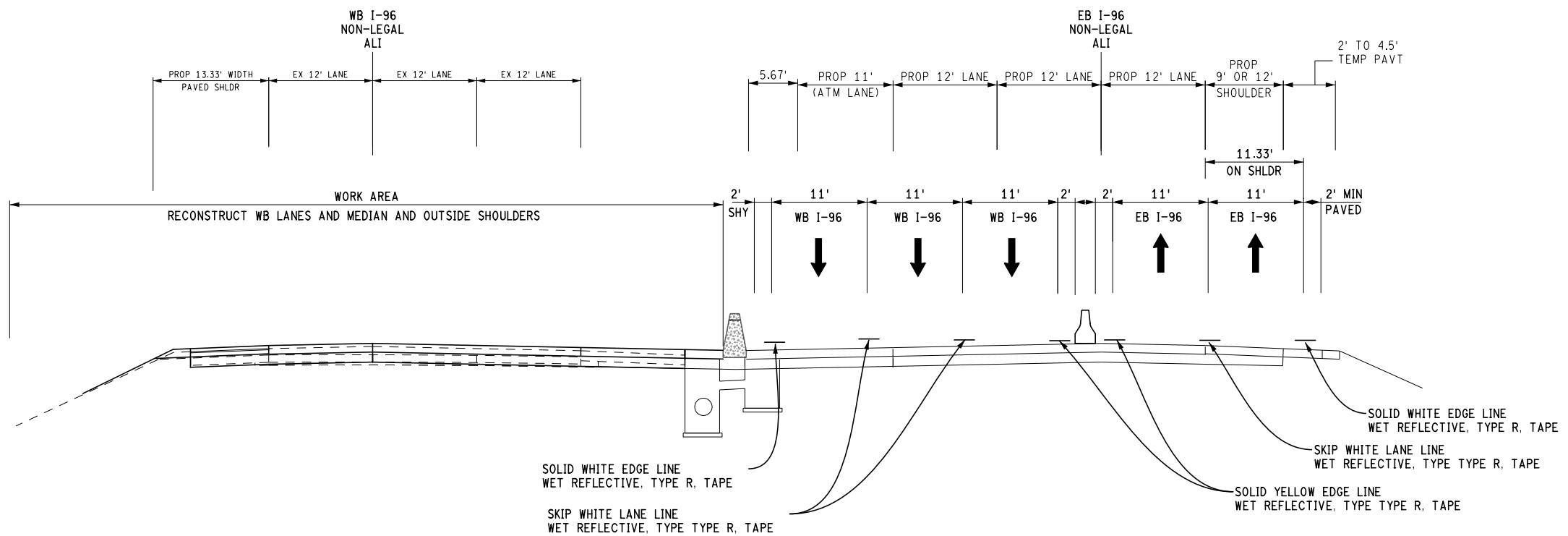

I-96 STAGE 5A TYPICAL 2

SECTION APPLIES:
WIXOM TO STA 589+19

FINAL ROW PLAN REVISIONS (SUBMITTAL DATE:)							
NO.	DATE	AUTH	DESCRIPTION	NO.	DATE	AUTH	DESCRIPTION

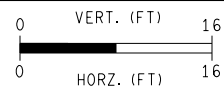

FILE: 124103PE_STG5A-1.dgn

DATE: 10/02/20
DESIGN UNIT: MARZ
TSC: OAKLAND

CS: 63022
JN: 124103

MAINTAINING TRAFFIC TYPICALS
I-96 FLEX ROUTE
STAGE 5A

DRAWING SHEET
I-96 MTTYP 9
SECT 1

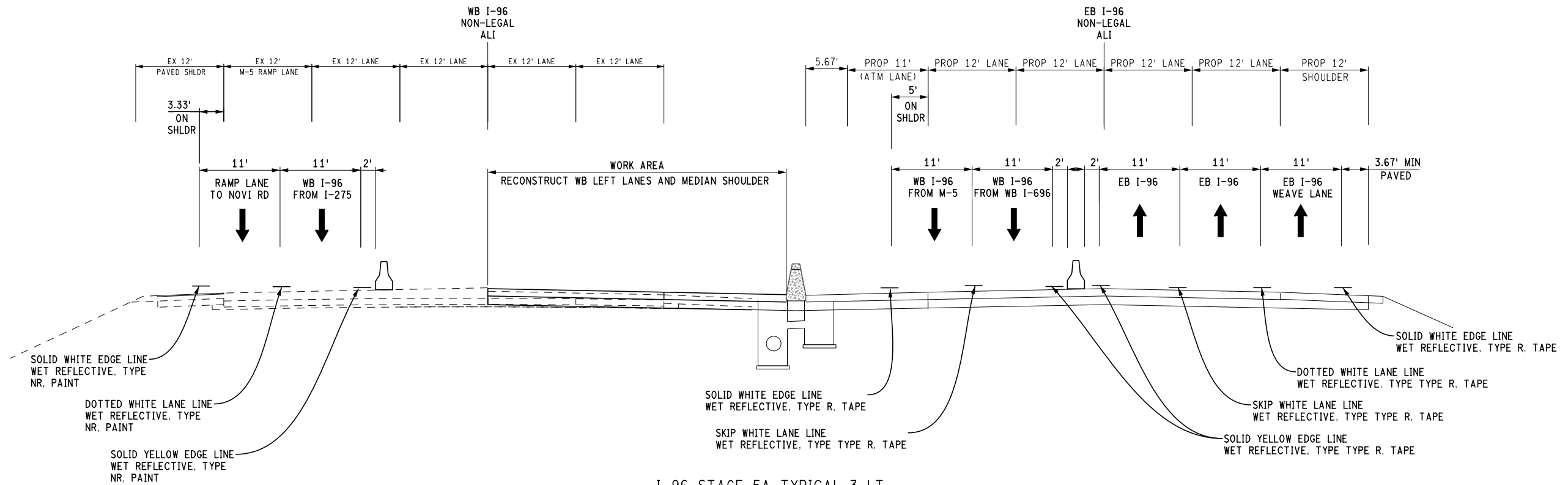

I-96 STAGE 5A TYPICAL 3 LT
 ENTRANCE RAMP FROM I-275 TO WB I-96- CONSTRUCT LEFT LANE/SHLDR

SECTION APPLIES:
 STA 609+00 TO STA 625+00

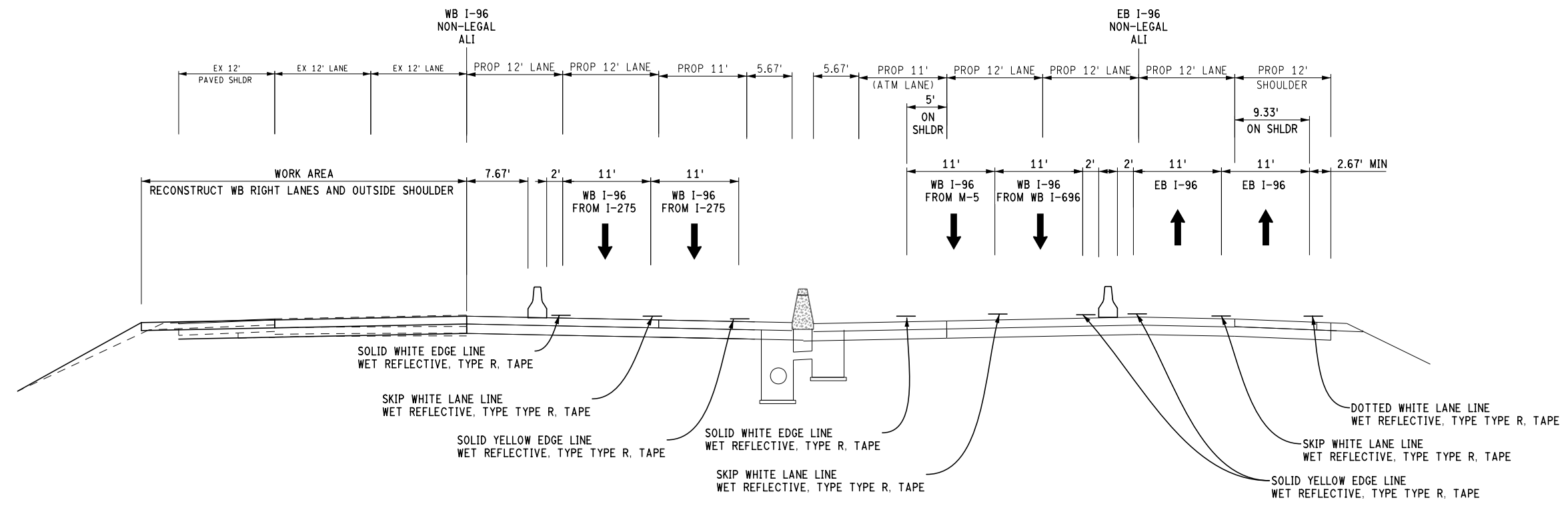

I-96 STAGE 5A TYPICAL 3 RT
 ENTRANCE RAMP FROM I-275 TO WB I-96- CONSTRUCT RIGHT LANE/SHLDR

SECTION APPLIES:
 STA 607+60 TO STA 38+49

FINAL ROW PLAN REVISIONS (SUBMITTAL DATE:)							
NO.	DATE	AUTH	DESCRIPTION	NO.	DATE	AUTH	DESCRIPTION

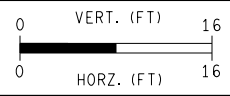

FILE: 124103PE_STG5A-2.dgn

DATE: 10/02/20
 DESIGN UNIT: MARZ
 TSC: OAKLAND

CS: 63022
 JN: 124103

MAINTAINING TRAFFIC TYPICALS
 I-96 FLEX ROUTE
 STAGE 5A

DRAWING SHEET
 I-96 MTTYP 10
 SECT 1

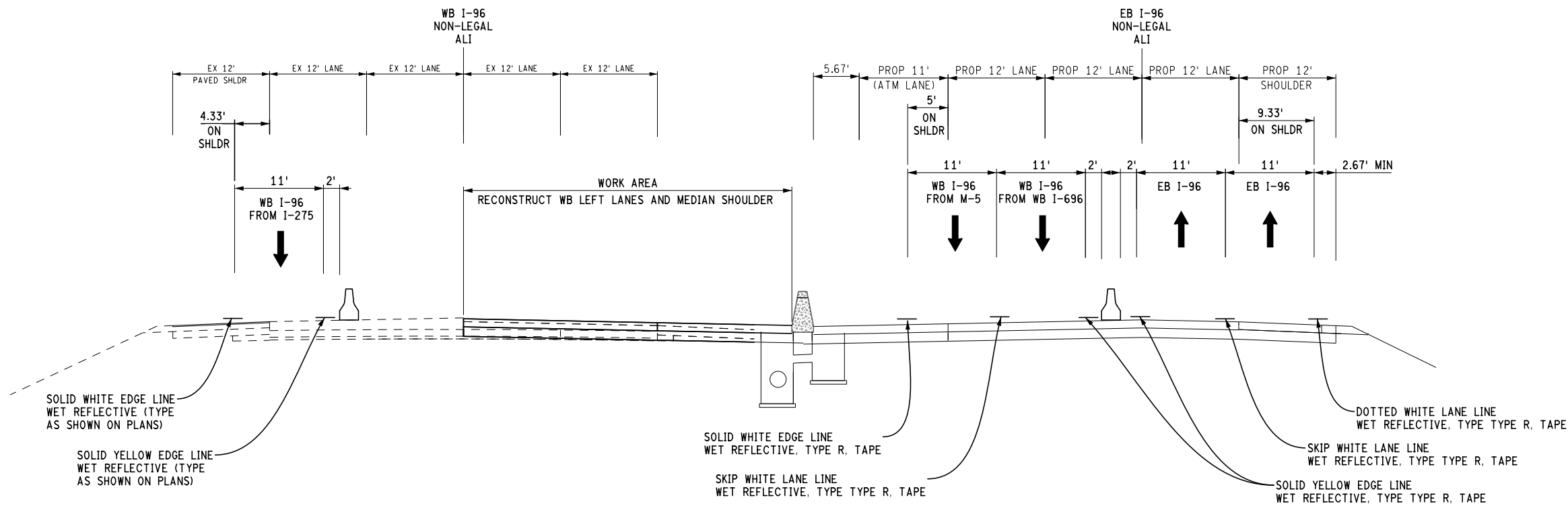

I-96 STAGE 5A TYPICAL 4 LT
EXIT RAMP TO NOVI RD- CONSTRUCT LEFT LANE/SHLDR

SECTION APPLIES:
 STA 625+00 TO STA 638+50

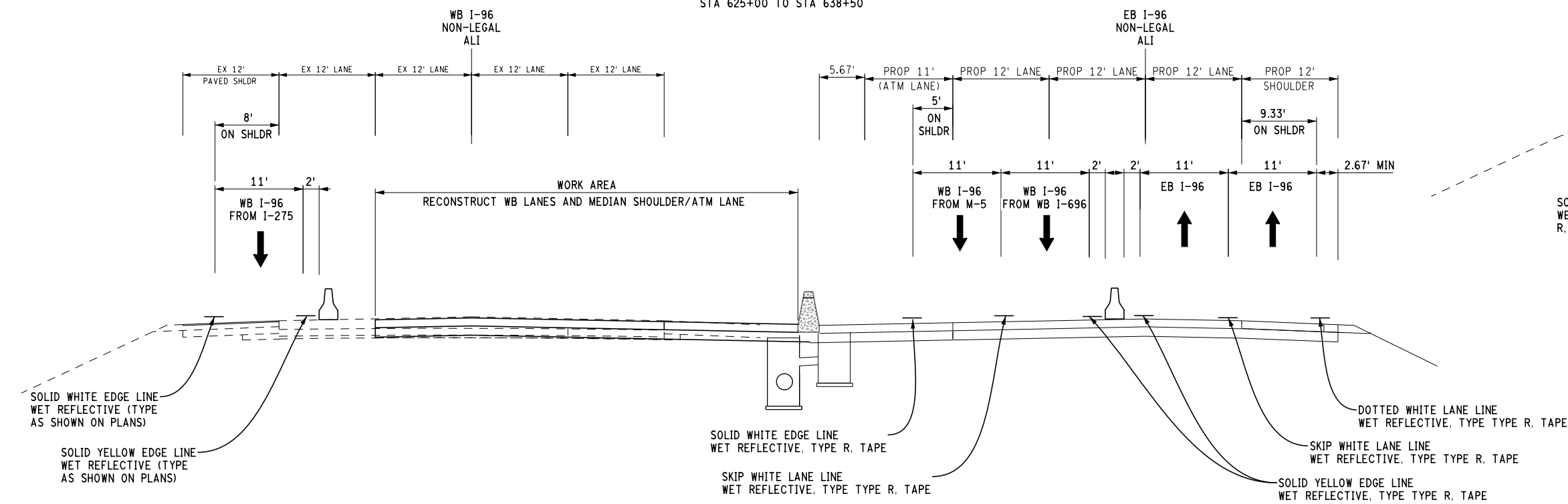

I-96 STAGE 5A TYPICAL 5 LT
EXIT RAMP TO NOVI RD- CONSTRUCT LEFT LANE/SHLDR

SECTION APPLIES:
 STA 638+50 TO STA 647+00

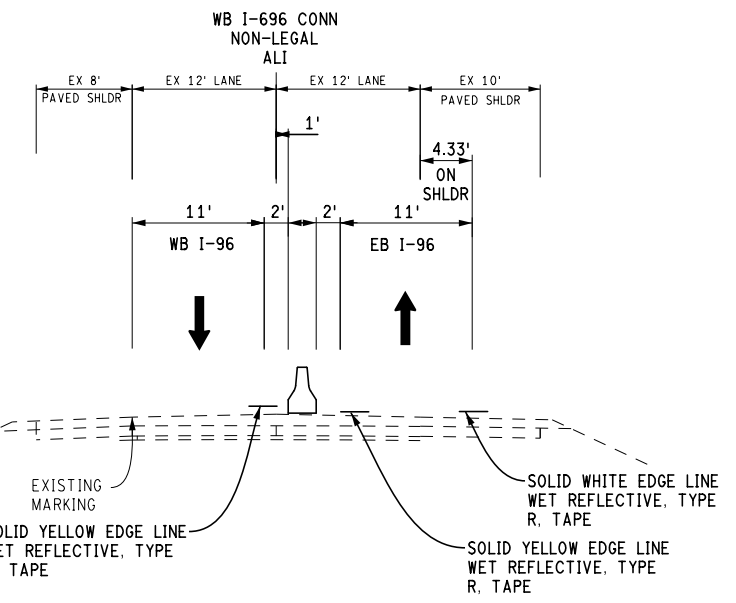

I-96 STAGE 5A CONNECTOR TYPICAL

SECTION APPLIES:
 STA 55+54 TO POE

FINAL ROW PLAN REVISIONS (SUBMITTAL DATE:)							
NO.	DATE	AUTH	DESCRIPTION	NO.	DATE	AUTH	DESCRIPTION



DATE: 10/02/20
 DESIGN UNIT: MARZ
 TSC: OAKLAND
 FILE: 124103PE_STG5A-3.dgn

CS: 63022
 JN: 124103

MAINTAINING TRAFFIC TYPICALS
 I-96 FLEX ROUTE
 STAGE 5A

DRAWING SHEET
 I-96 MTTYP 11
 SECT 1

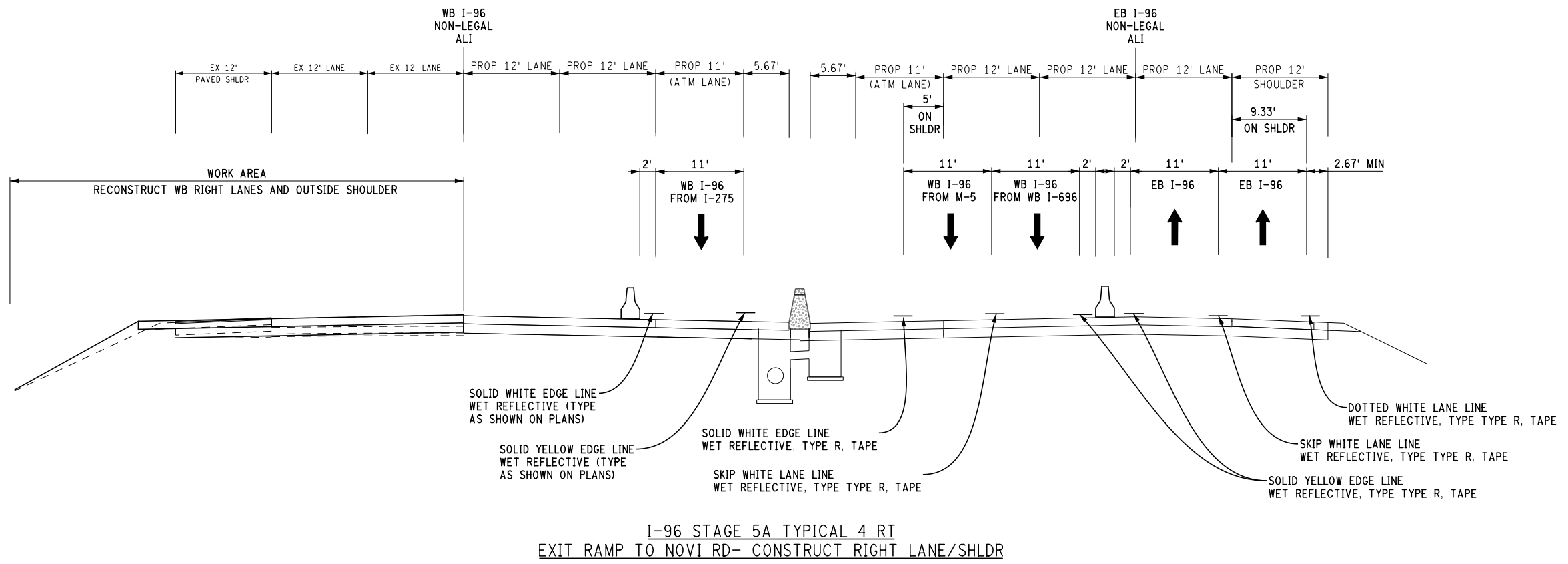

SECTION APPLIES:
STA 625+00 TO STA 638+50

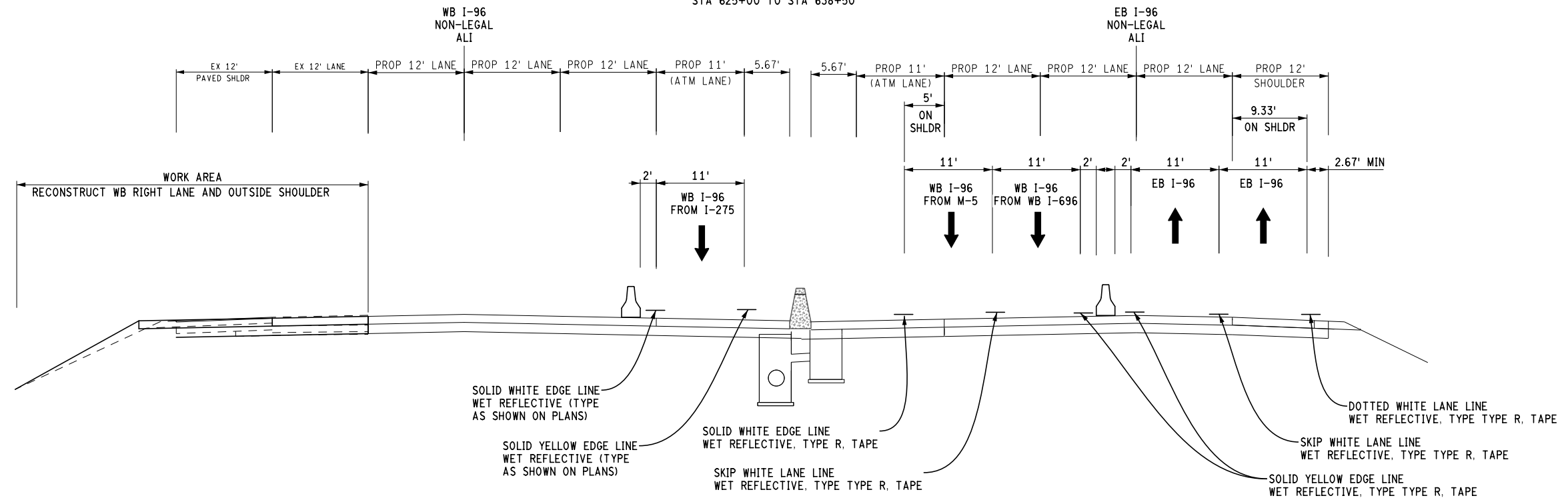

SECTION APPLIES:
STA 638+50 TO STA 647+00

FINAL ROW PLAN REVISIONS		(SUBMITTAL DATE:)	
NO.	DATE	AUTH	DESCRIPTION

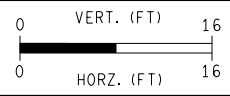

FILE: 124103PE_STG5A-4.dgn

DATE: 10/02/20
DESIGN UNIT: MARZ
TSC: OAKLAND

CS: 63022
JN: 124103

MAINTAINING TRAFFIC TYPICALS
I-96 FLEX ROUTE
STAGE 5A

DRAWING SHEET
I-96 MTTYP 12
SECT 1

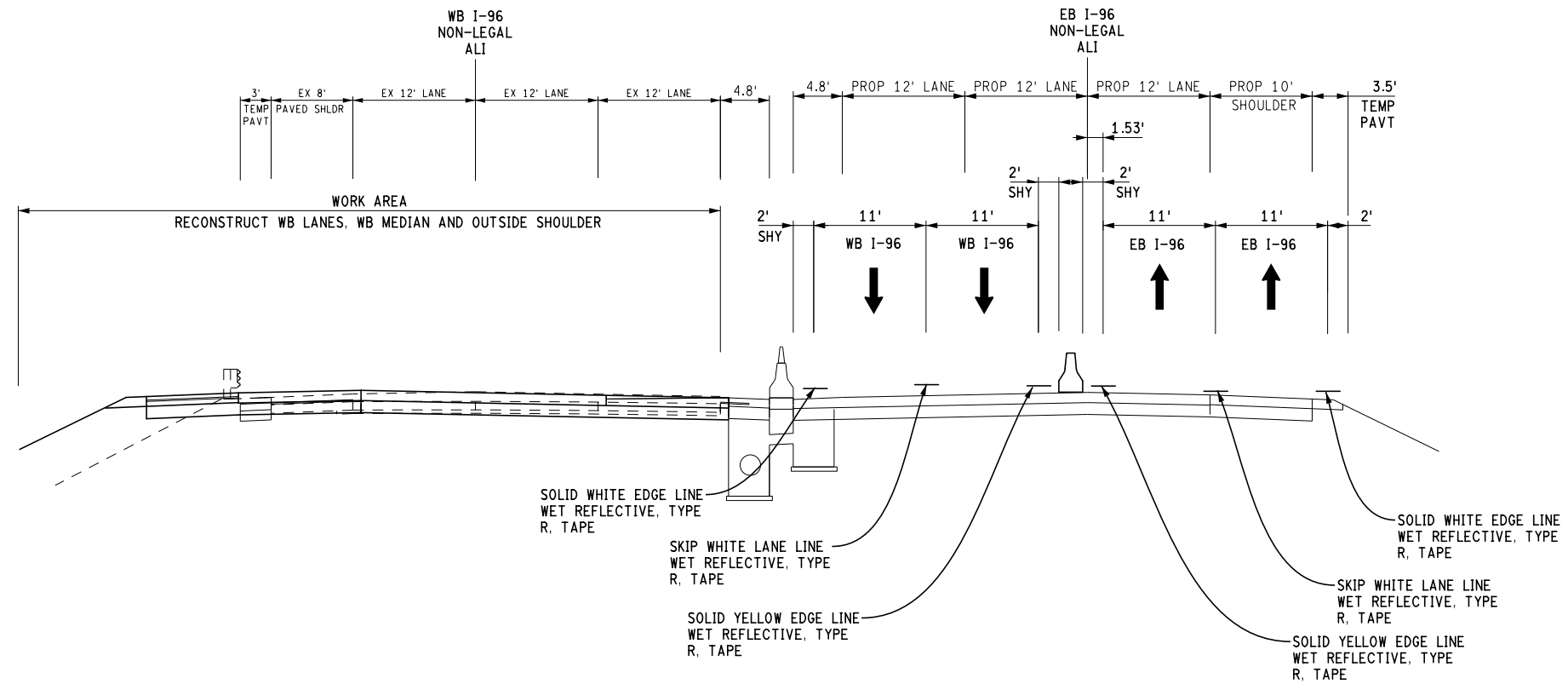

I-96 STAGE 5B TYPICAL 1

SECTION APPLIES:
POB TO STA 90+59

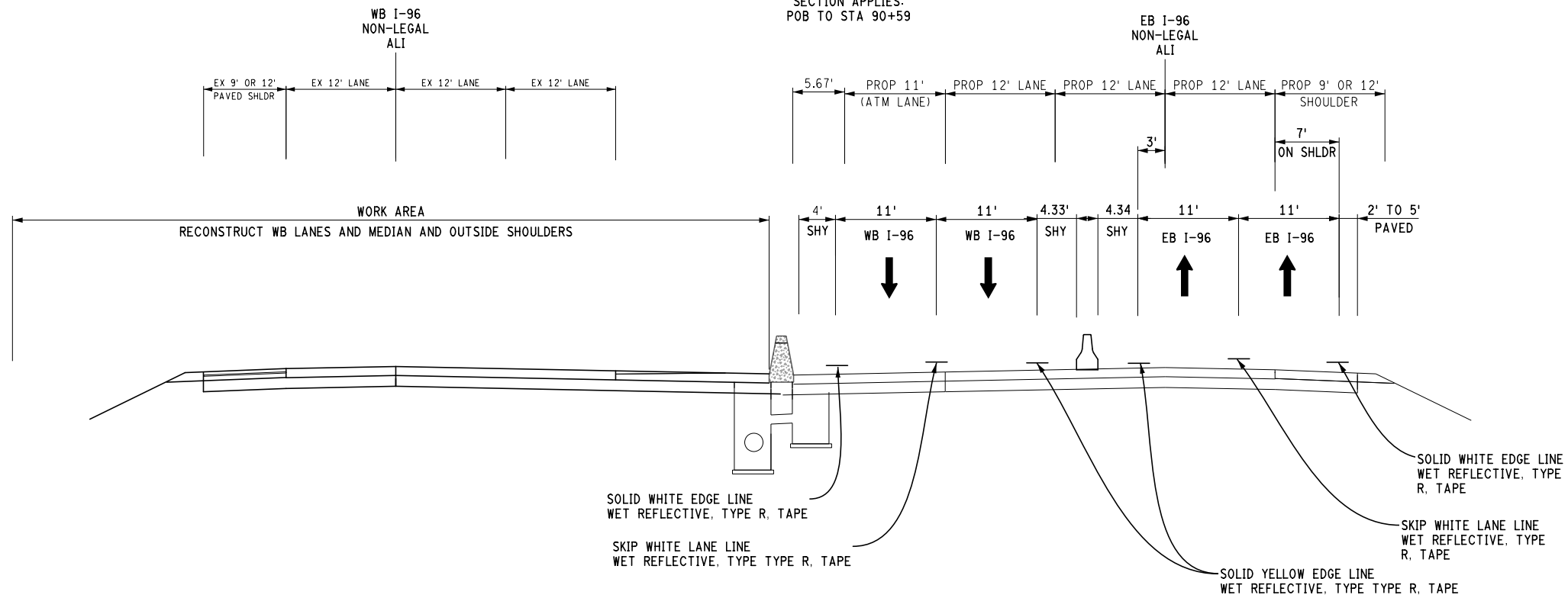

I-96 STAGE 5B TYPICAL 2

SECTION APPLIES:
STA 90+59 TO WIXOM RD

FINAL ROW PLAN REVISIONS		(SUBMITTAL DATE:)	
NO.	DATE	AUTH	DESCRIPTION

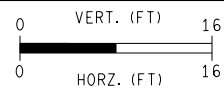

FILE: 124103PE_STG5B-1.dgn

DATE: 10/02/20
DESIGN UNIT: MARZ
TSC: OAKLAND

CS: 63022
JN: 124103

MAINTAINING TRAFFIC TYPICALS
I-96 FLEX ROUTE
STAGE 5B

DRAWING SHEET
I-96 MTTYP 12
SECT 1

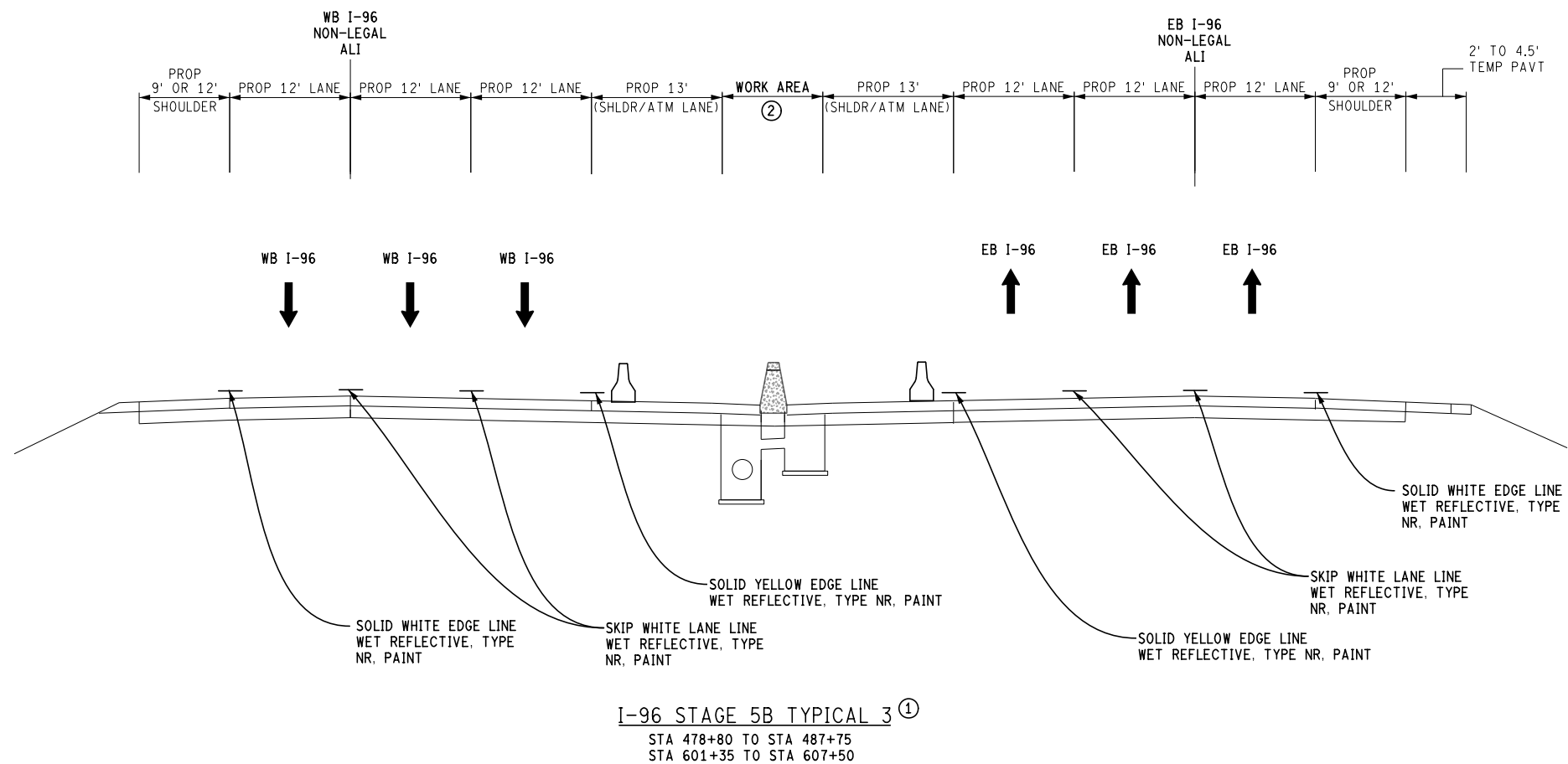

- ① STAGE 6 (NOT SHOWN) IS TO PLACE THE TOP COURSE ON EB AND WB I-96. USE NIGHT AND WEEKEND LANE CLOSURES TO COMPLETE THE WORK. STAGE 6 WORK BETWEEN WIXOM RD AND THE POE CAN BEGIN DURING STAGE 5B.
- ② WORK AREA- REMOVE TEMP PAVEMENT AND PLACE EB/WB VALLEY GUTTER AND MEDIAN BARRIER WALL.

FINAL ROW PLAN REVISIONS				(SUBMITTAL DATE:)			
NO.	DATE	AUTH	DESCRIPTION	NO.	DATE	AUTH	DESCRIPTION

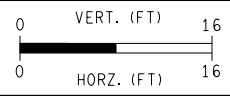

FILE: 124103PE_STG5B-2.dgn

DATE: 10/02/20
 DESIGN UNIT: MARZ
 TSC: OAKLAND

CS: 63022
 JN: 124103

MAINTAINING TRAFFIC TYPICALS
 I-96 FLEX ROUTE
 STAGE 5B

DRAWING SHEET
 I-96 MTTYP 13
 SECT 1